

# VIA Rail Canada

## Evolution in railway interiors

# VIA Rail Canada - Who we are

An independent Crown Corporation since 1977 providing passenger rail service across Canada

- 497 trains weekly
- 450 communities
- 12,500 KM (7813 miles) of tracks (233 owned by VIA, 12,267 owned by 10 freight operators)
- 396 passenger cars
- 78 active locomotives
- 159 railway stations
- 4 maintenance facilities (Montreal, Toronto, Winnipeg, Vancouver)
- 3,000 amazing people
- 4 million passenger (80% in the Québec-Windsor Corridor)



# VIA Rail Canada – Where we go



# The Canadian - A majestic experience – A beautiful tradition

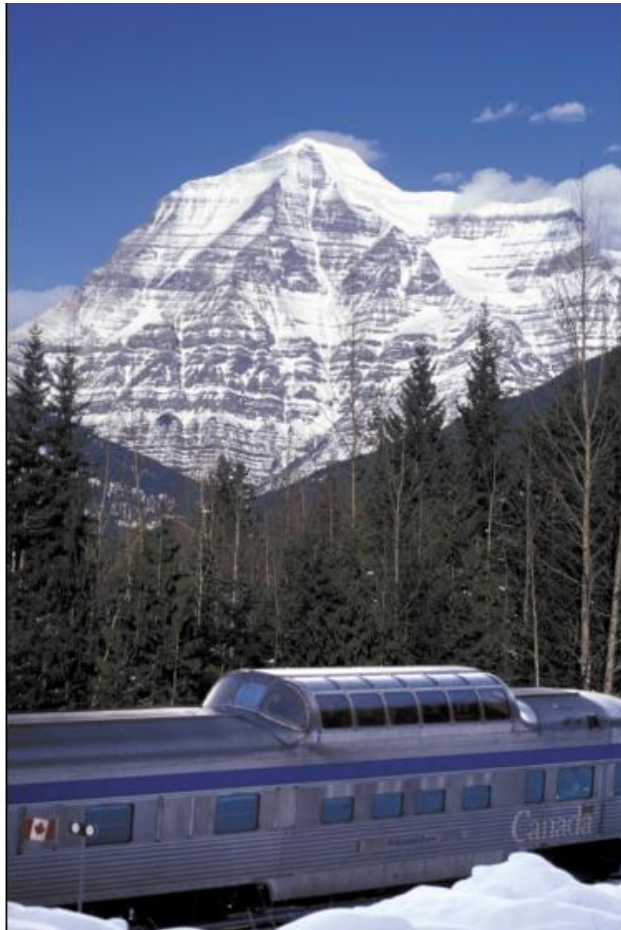



# The Canadian - What makes it special

Unique experience, amazing scenery, world class service and top notch dining.



## The Canadian - Key facts

- 3 X per week each way Toronto-Vancouver (2X in off-peak winter)
- Total distance 4,466 KM
- Total trip time 84 hours (4 nights)
- 2 classes: Economy and Sleeper PLUS
- 150,000 passengers a year – 70% domestic, 30% international
- Stainless Steel HEP equipment

# The Canadian - Skyline and dining car



Skyline Car

Scenic Dome / Salon panoramique

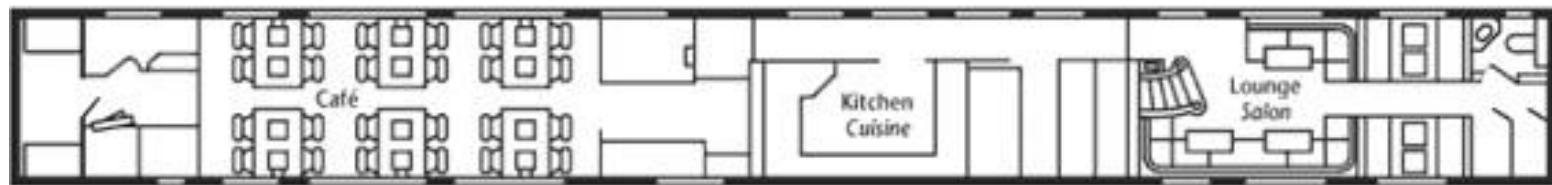
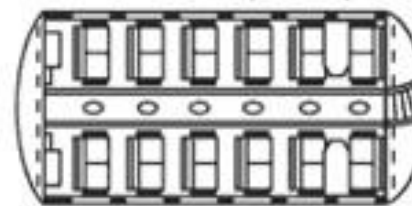

Dining Car

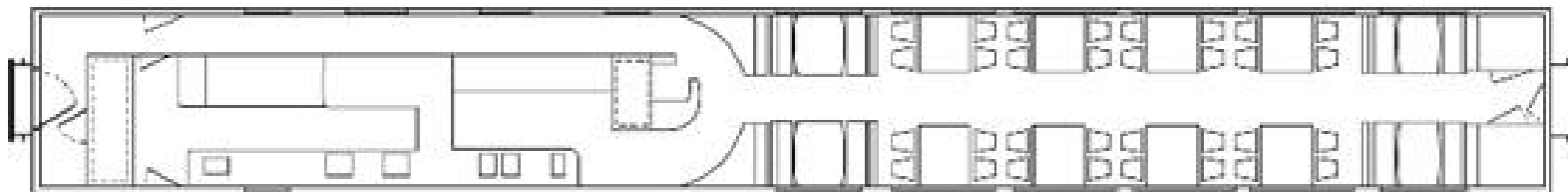

# The Canadian - Park car

Park Car



Scenic dome section

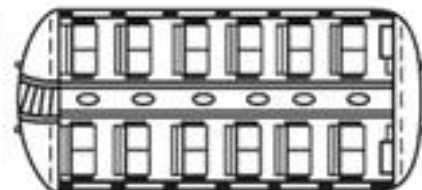



# The Canadian - Panorama Car

## Panorama Dome Car

Colorado Rail Car



# The Canadian - Sleeper cars

## Manor Sleepers

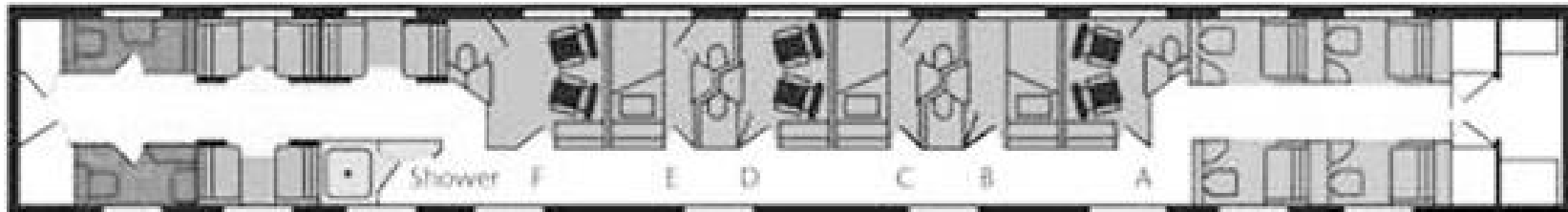

## Chateau Sleepers

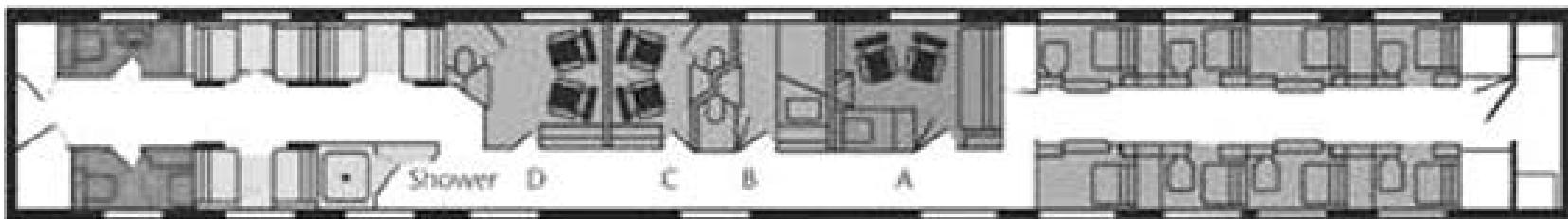

## The Canadian – Equipment History

- 1950: Original construction of HEP cars
- 1990: Renovated interiors – Streamline Design style (Silver & Blue Class)
- 2005: Launch of design contest for Hotel VIA product concept
- 2009: Superior court of Canada ruling on accessibility
- 2009: Government approval of funds for Capital Programs, including new interiors
- 2010: Renovated interiors in most cars: Boutique hotel style
- 2010: Beginning of design and engineering on the Deluxe cars
- 2013: First 2 cars expected to be completed in Dec.

# The Canadian – MOS renovations

Carried out at VIA's Montreal Maintenance Center in 2010 and 2011

- 3 Park Cars
- 4 Skylines
- 40 Manor Sleepers
  
- Floor plans and furniture unchanged
- New carpet, wall & ceiling coverings, window blind, seat coverings
- Improved Dome, Lounge sectional and Dinette seating upholstery

# The Canadian – MOS renovations

## Skyline



**BEFORE**





# The Canadian – MOS Renovations Diner



Original light sconces replaced with new down-light fixtures. White LEDs with limited dimming: every second light can be turned off.



**BEFORE**



# The Canadian – MOS Renovations

## 40 Manor Sleepers

Leather

Wood

Leather

Carpet

Decorative  
Film



**BEFORE**

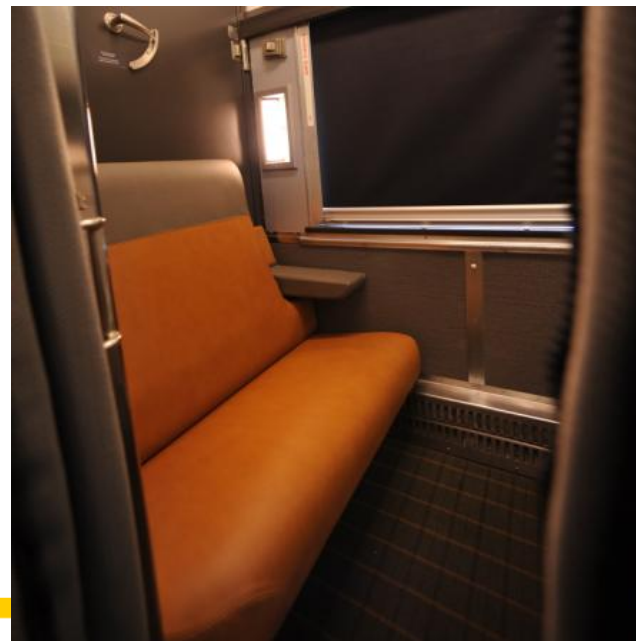

Manor Car  
single cabin



# The Canadian – MOS Renovations

## 40 Manor Sleepers



BEFORE



Manor Car  
cabin for 2



Manor Car  
section

# The Canadian – MOS Renovations Park Car

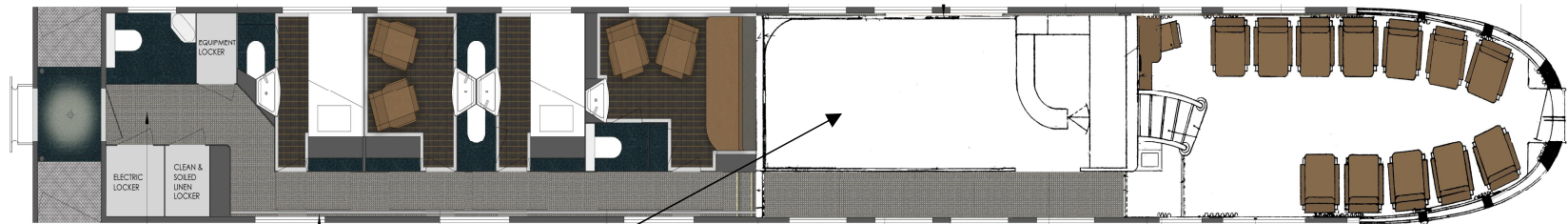

Leather

Wood

Leather

Carpet

Décor.  
Film





# **The Canadian – Tomorrow**

**12 reconfigured cars  
to be completed between 2013 and 2014**



# The Canadian – All suites cars

## 8 reconfigured Château Sleepers

- Design competition in 2005
- Built prototype in rail container - toured the country
- Obtained the funds in 2010 – now in development
- 12 cars completely gutted
- Concierge cabin in each car
- En-suite Cabin:
- 6 identical cabins in each sleeper– capacity 2 per cabin, 75 sq ft
- Double “Murphy” bed
- Sectional leather seating
- Upscale duvets and linens
- Mini fridge
- Flat screen TV with managed content (Wi-Fi in later phase)
- En-suite bathroom with glass door shower, heated floors, hair dryer
- Total expenditure \$34 Mil. CAD



# The Canadian – All suites cars

8 reconfigured Château Sleepers



Mock-up, not final design

# The Canadian – Tomorrow

## 4 Park Cars with extensive accessibility features

- 2 cabins : 1 deluxe and 1 fully accessible
- Reconfigured Park cars will also have hydraulic wheelchair lifts on both sides of the Park car vestibules.

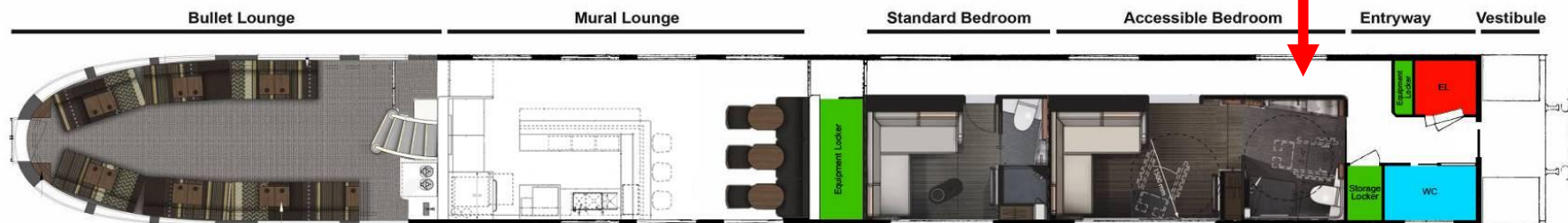



# The Canadian – Tomorrow

## Mural Lounge in the Park Car



Renderings not to scale



Prototype sectional seating

# The Canadian – Tomorrow

## Proposed Livery - Sleepers

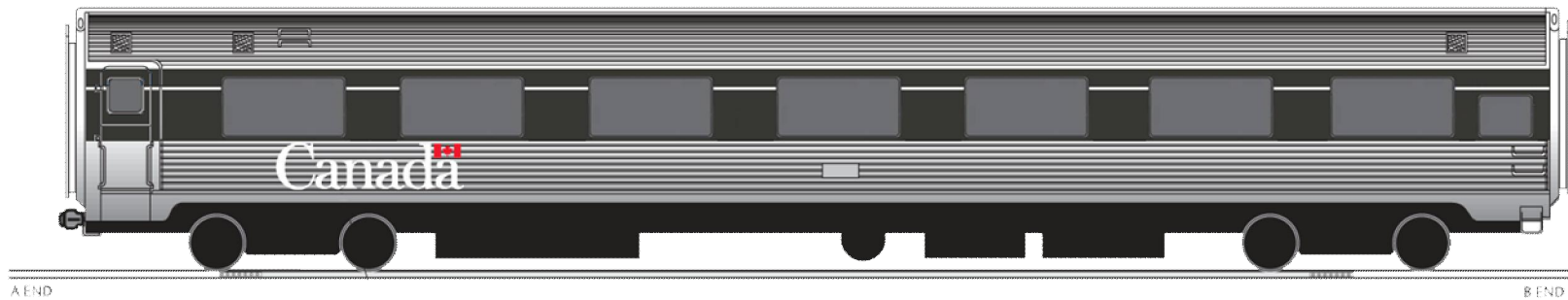
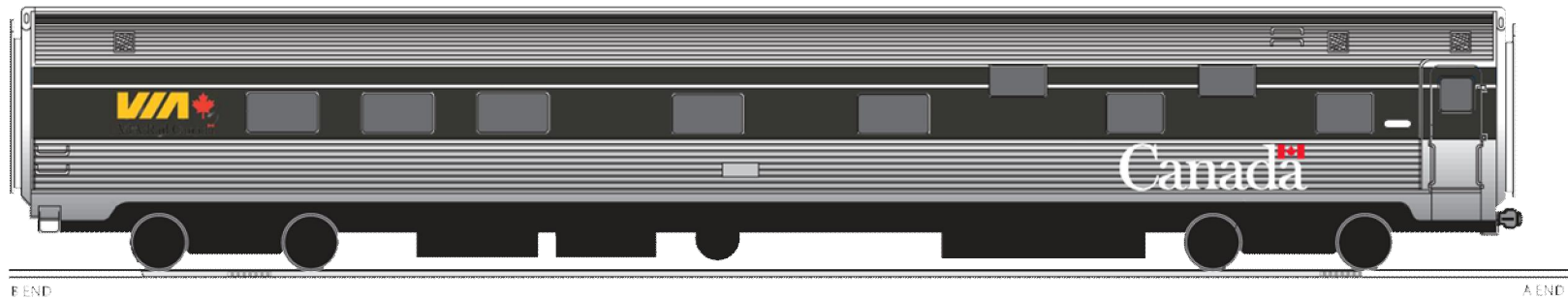



# The Canadian – Tomorrow

Proposed Livery - Park Car

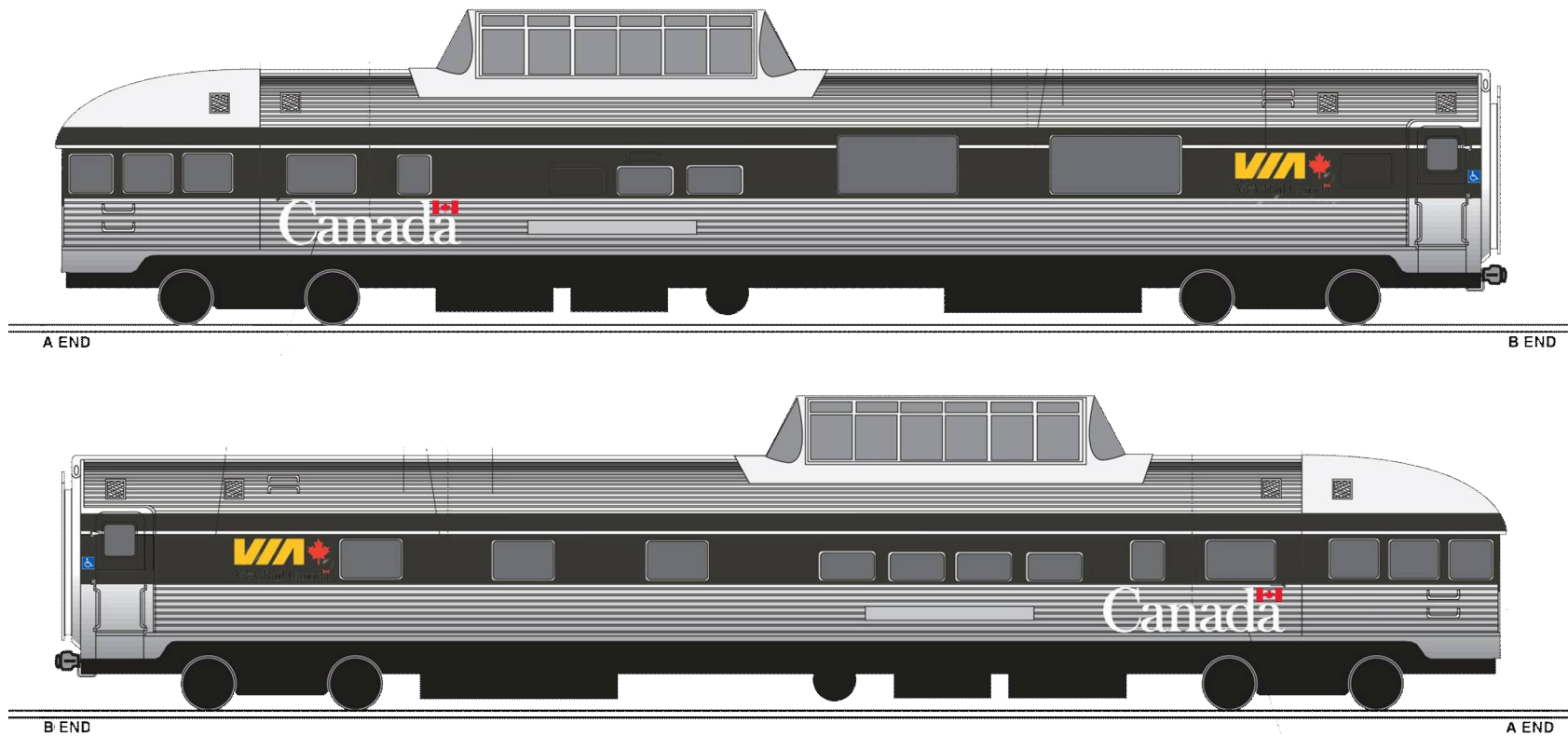

# Deluxe Class

## Service Design:

- Summer peak season only
- 2 deluxe sleepers and one deluxe Park car added to the Canadian
- Guests share all services – dining car, Skylines and Panorama cars
- Exclusive events in Park car
- Red carpet welcome
- Full concierge service with personalized learning components
- Price point from \$3000 per person CAD, train only (4night trip)

# Other VIA Rail interiors Projects

## Québec City – Windsor Corridor:

- 71 economy cars: 10 LRCs completed – balance over next 2 years
- 26 business class car interiors in progress, completion March 2014
- 6 renaissance cars with larger accessible washrooms



# Renaissance Accessible Sleepers





***Bon Voyage !***